

Copyright. All information furnished within this document, electronic file or design correspondence is the property of Den Hartog industries, Inc. and shall not be used, disclosed to others or copied without the expressed written consent of Den Hartog Industries, Inc.

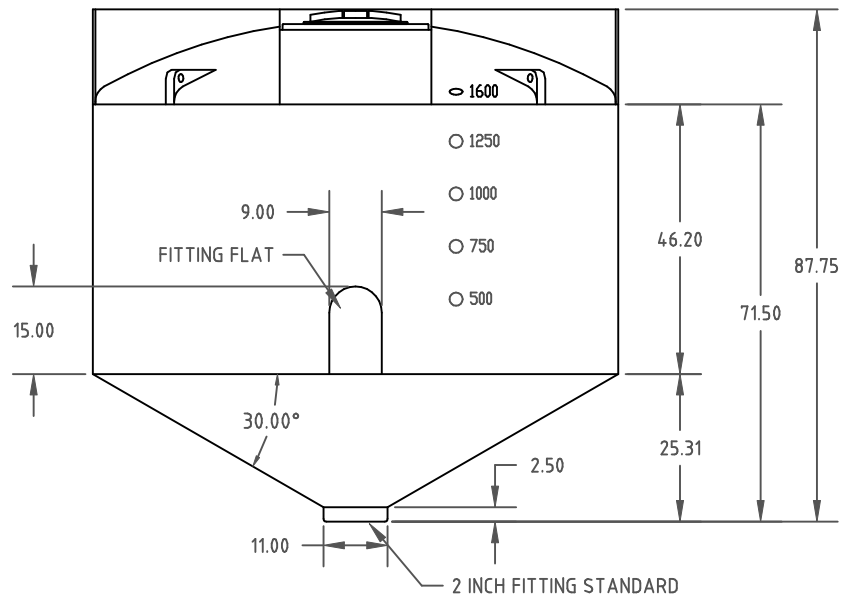

				DRAWN / DATE DHJ 1/3/11	MATERIAL 10420 3 MELT
				APPRD. / DATE REH 2/2/11	
REV	DESCRIPTION	BY / DATE	CCN	SHOT WEIGHT: 284 LBS.	NOTES: 1. THICKNESS @ BOTTOM SIDEWALL .326
				SHIPPING WEIGHT: 286 LBS.	
				FINISH:	

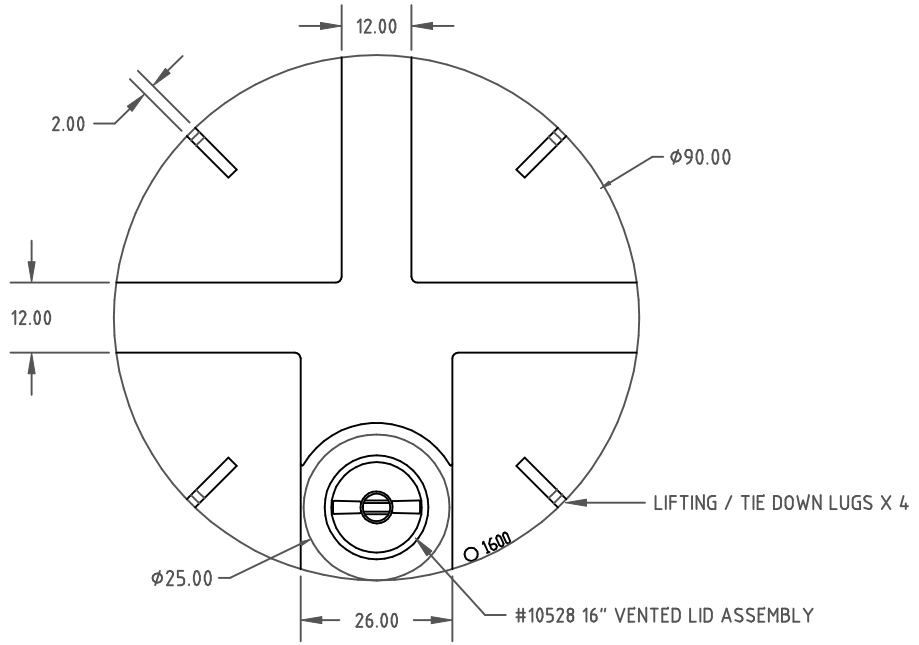

Den Hartog

INDUSTRIES, INC.

Ace Roto-Mold Injection Molding Blow Molding Sow-Joy
4010 HOSPERS DRIVE S. BOX 425, HOSPERS, IOWA 51238-0425

DESCRIPTION	1550 GALLON 90" DIA. X 30° CONE BOTTOM TANK W/ INDUSTRIAL TOP		
SCALE	N.S.	PART NO.	CB1550-90

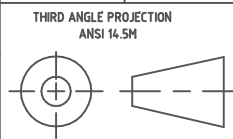

ALL DIMENSIONS ARE IN DECIMAL INCHES
TOLERANCES UNLESS OTHERWISE SPECIFIED

POLYETHYLENE
±1% @ 68° F

METAL
DECIMAL ± .125"
FRACTION ± 1/4"
ANGLE ± 1°