

© DEN HARTOG INDUSTRIES, INC.

Copyright. All information furnished within this document, electronic file or design correspondence is the property of Den Hartog industries, Inc. and shall not be used, disclosed to others or copied without the expressed written consent of Den Hartog Industries, Inc.

FS2600-SK

E

KEY	PART NUMBER	DESCRIPTION	QTY.
1	FS2600-SK-1	SIDE CHANNEL	2
2	FS2600-SK-2	SUPPORT CHANNEL	6
3	FS2600-SK-3	SUPPORT CHANNEL (HOLES)-LEFT	3
4	FS2600-SK-4	SUPPORT CHANNEL (HOLES)-RIGHT	3
5	FS2600-SK-5	TOP SUPPORT PLATE-SMALL	2
6	FS2600-SK-6	TOP SUPPORT PLATE-LARGE	2
7	FS2600-SK-7	TOP SUPPORT PLATE	1
8	FS2600-SK-8	SPLIT TOP SUPPORT PLATE	4
9	FS2600-SK-9	BASE SUPPORT PLATE	4
10	FS2600-SK-10	BASE SUPPORT PLATE-LARGE	4
11	FS2600-SK-11	BASE SUPPORT PLATE-SMALL	4
12	12411	5" X 5" GUSSET	8
13	13201	PLATE, POWDER COATING	2

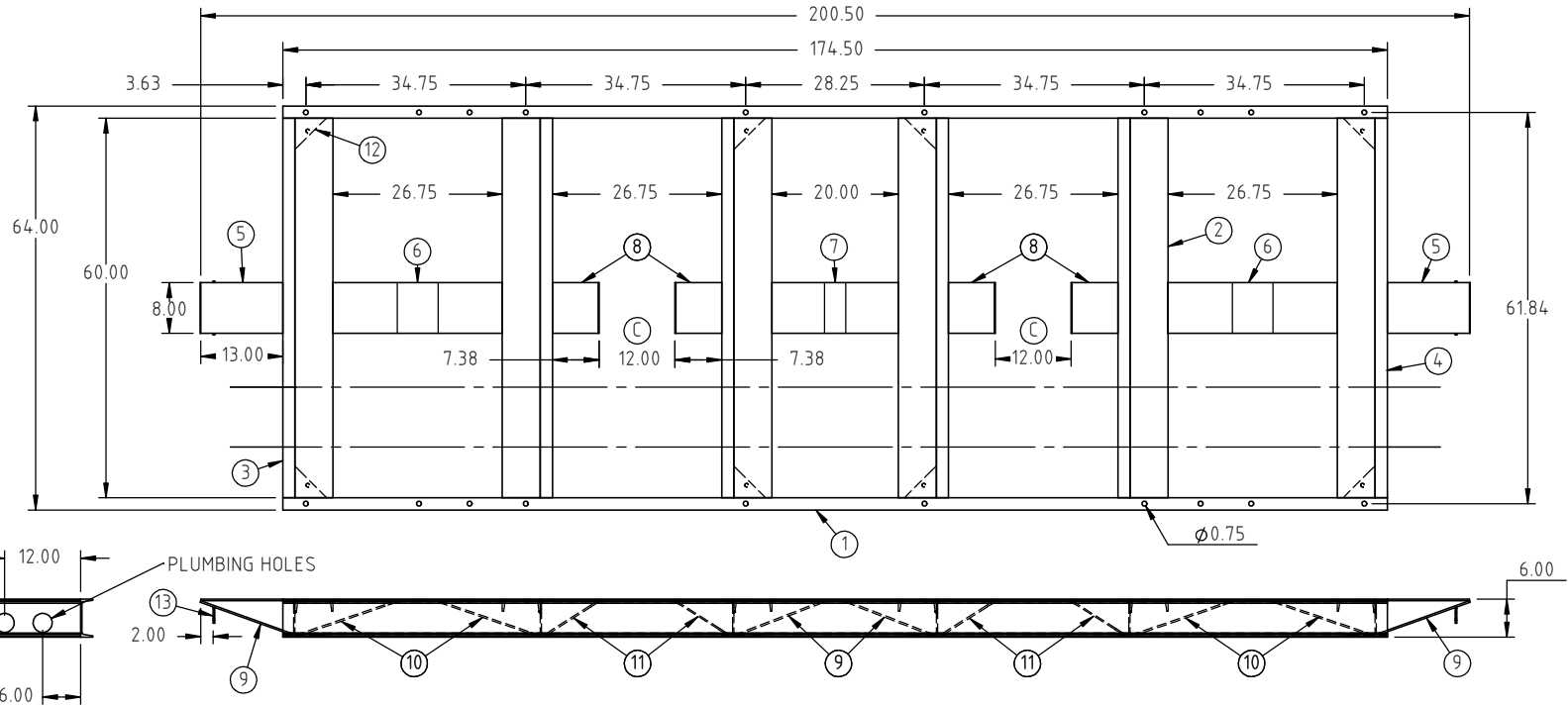

E	PRINTS 2.25 WAS 2.50, LOCATION CORRECTED, POWDER COATING PLATE ADDED, WEIGHT/FINISH ADDED	ADH 8/2/12	2465
D	TABLE ADDED TO DRAWING, DRAWING TEMPLATE UPDATED.	ADH 3/27/09	1828
C	INCREASE SUMP CLEARANCE	DHJ 11/2/07	
B	ADD GUSSETS	9/22/06	
A	ADD PLUMBING HOLES	3/29/06	
REV	DESCRIPTION	BY / DATE	CCN

DRAWN / DATE	MATERIAL
REH/01/28/02	
APPRD. / DATE	
DHJ / 1/28/01	



**Den Hartog**  
INDUSTRIES, INC.

Acra Roto-Mold Injection Molding Blow Molding Blowjey

4010 HOSPERS DRIVE S. BOX 425, HOSPERS, IOWA 51238-0425

ALL DIMENSIONS ARE IN DECIMAL INCHES  
TOLERANCES UNLESS OTHERWISE SPECIFIED

POLYETHYLENE  
±1% @ 68°F

THIRD ANGLE PROJECTION  
ANSI 14.5M

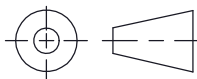

SHOT WEIGHT:

SHIPPING WEIGHT:  
900.00 LBS

FINISH: POWDER COATING,  
BLACK TILE, 40012

NOTES:

DESCRIPTION	2600 GALLON TANK SKID	
SCALE	N.S.	PART NO. FS2600-SK